

Information for visitors

Hours of Operation Weekdays | 10 AM – 6 PM (Last admission is at 5:30 PM)
※ The Museum is open until 9 PM on the last Wednesday of every month.
Weekends and Holidays | 10 AM – 7PM
(Extended by one hour)
March – October | Open until 9 PM every Saturday

Admission Fees Free (Special exhibition carry a separate charge.)

Closed Days January 1st, Seollal (Lunar New Year's Day), Chuseok (Korean Thanksgiving Day)

Close on January 1st, Seollal (Korean New Year's Day) and Chuseok (Korean Thanksgiving Day).
It may be closed temporarily when ordered due to COVID-19.

Guided Tours

Guided Tours for Individuals
When | Monday – Saturday : 10 AM – 4 PM (Except Closed Days)
Guided tours for individuals can be arranged on the day of your visit or can be reserved at least one day before a planned visit via the museum website. After an advance booking, a museum staff member will call to confirm the reservation. (Tours booked on the day of a visit may be subject to change according to the museum's schedule.)

Guided Tours for Groups
Who | Groups of 30 or more
When | Monday – Saturday: 10 AM – 4 PM (Except Closed Days)
Guided tours for groups can be reserved at least one week in advance via the museum website. We suggest that the number of people in a group tour be limited to 30 in order to provide effective guided tours and make the visit more comfortable. After the advance booking, a museum staff member will call to confirm your reservation.
Contact Information | +82-63-220-1055 (10 AM – 6 PM, Except Closed Days)

Visitor Guidelines

- Please do not touch exhibited items in the museum.
- Photography without a flash or a tripod is permitted. Smoking, food, and pets are prohibited.
- Please silence cell phones while in the galleries.



(55070) 249, Ssukgogae-ro, Wansan-gu, Jeonju-si,
Jeollabuk-do * Republic of Korea
Tel +82-63-223-5651, 5652 Fax +82-63-223-5653

...

Medieval and Early Modern History Gallery

Ancestors of the Joseon royal family settled in Jeonju, an affluent city energetically engaged in bustling economic activities. The city served as a center of arts and culture, particularly in the eighteenth century, publishing a variety of complete woodblock-printed books for the public. Jeonju also produced a number of leading intellectuals, including Seokji Chae Yong-sin (石芝 蔡龍臣, 1850-1941), Changam Yi Sam-man (蒼巖 李三晩, 1770-1847), Seokjeong Yi Jeong-jik (石亭 李定積, 1841-1910), Yeoam Shin Gyeong-jun (旅菴 申景澮, 1712-1782), and Yijae Hwang Yun-seok (頤齋 黃胤錫, 1729-1791). In this gallery, visitors will be introduced not only to the history and culture of North Jeolla-do Province, but also to the cultural heritage left by the pioneering intellectuals from the area.

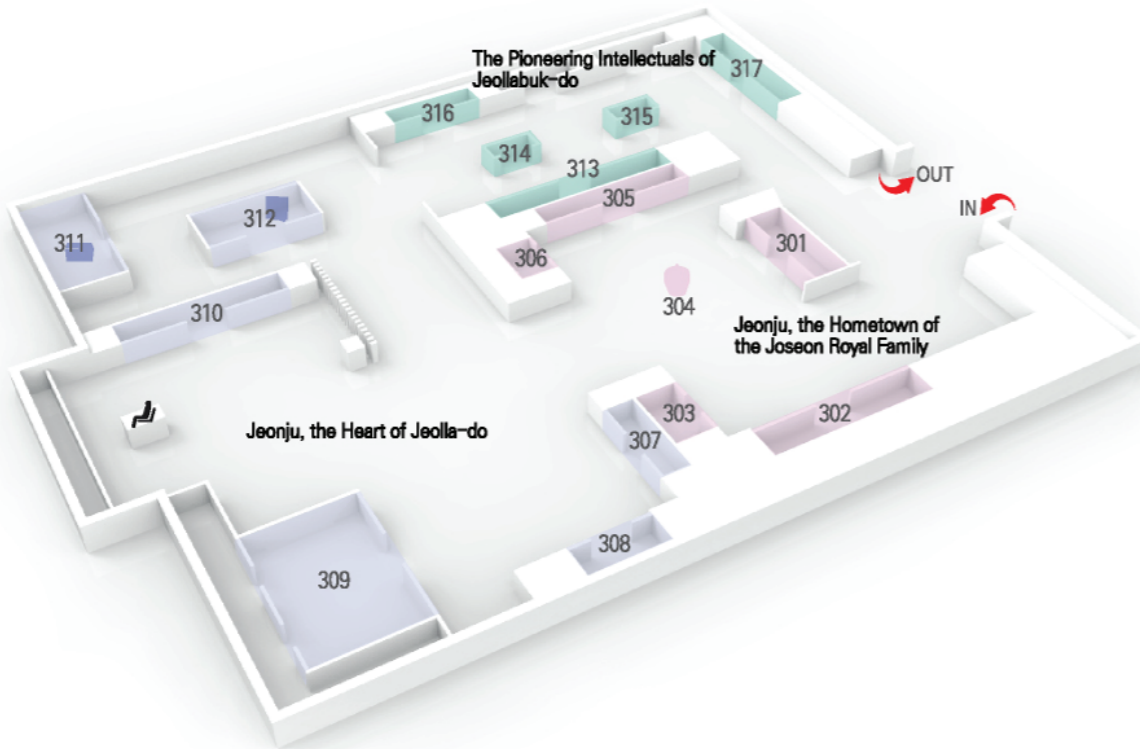

301 Portrait of King Taejo



304 Placenta Jar of King Yejong



310 Detail of Gyeonggijeon Hall on the Map of Wansan



312 Jeonjujang (Banda) Chest

2F

Major Exhibits

- Jeonju, the Hometown of the Joseon Royal Family
 - 301 Portrait of King Taejo, the Founder of the Joseon Dynasty
 - 302 Genealogy Book of the Jeonju Yi Family
 - 303 Eoje sudock jeonpyeon (Confucian Text by King Yeongjo)
 - 304 Placenta Jar of King Yejong
 - 305 Rubbing of Commemorative Stele of Jojongdang Memorial Altar
 - 306 Seal of Emperor Gojong

- Jeonju, the Heart of Jeolla-do
 - 307 Guwen zhenbao (Veritable Treasures of Ancient Writings)
 - 308 Jeonun okpyeon (Dictionary of Chinese Characters)
 - 309 Sarangbang (Scholar's Studio)
 - 310 Detail of Gyeonggijeon Hall on the Map of Wansan
 - 311 Lacquered Box with Inlaid Mother-of-Pearl
 - 312 Jeonjujang (Banda) Chest

- The Pioneering Intellectuals of Jeollabuk-do
 - 313 Folding Screen with Calligraphy by Yi Sam-man
 - 314 Yisu sinpyeon (New Edition on Science and Mathematics)
 - 315 Yeonseoksanbang mijong mungo (Collection of Incomplete Manuscripts by Yi Jeong-jik)
 - 316 Portrait of Kim Cheol-sang
 - 317 Folding Screen with Literati Painting by Yi Jeong-jik

Seokjeon Memorial Hall

Seokjeon Memorial Hall honors the renowned calligrapher Hwang Uk (黃旭, 1898-1993), also known by his pen name Seokjeon (石田). The establishment of this memorial hall began with a donation of over 5,000 cultural assets by Hwang Byeong-geun, the son of Hwang Uk, to the Jeonju National Museum in 1999. It opened in November 2011 and showcases about 150 items, including Hwang Uk's calligraphic works, family relics, old books, and letters. In this hall, visitors can encounter and appreciate not only early works by Seokjeon, but also the products of other calligraphers who had a significant influence on Seokjeon, including Jaha Sin Wi (紫霞 申緯, 1769-1845) and Changam Yi Sam-man (蒼巖 李三晩, 1770-1847).

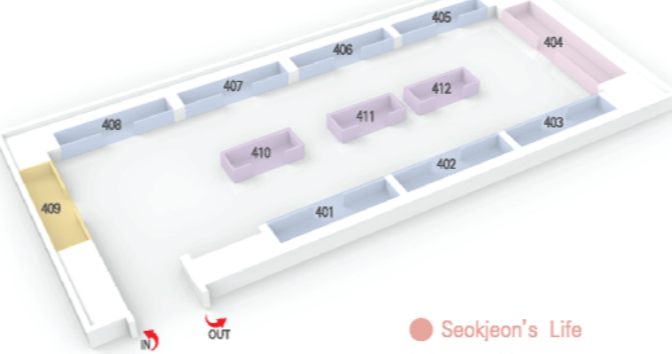

Seokjeon's Calligraphic Works

- 401 Ungang Study
- 402 Folding Screen with Pentasyllabic Poem
- 403 Serving as if Worshipping the Spirits
- 405 By Revering Heaven, You Will Understand the Truth of Heaven
- 406 Couplet of Heptasyllabic Poem
- 407 Review the Old to Better Understand the New
- 408 Folding Screen with Heptasyllabic Poem



404 Relics of Seokjeon Hwang Uk



412 Bangye surok (Treaties on Political and Social Reformation by Yu Hyeong-won)

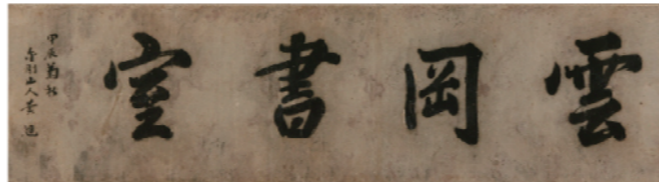

401 Ungang Study



407 Review the Old to Better Understand the New

...

Children's Museum

The Children's Museum was established on the theme of the virtual childhood of Oseong and Haneum, who were important seonbi of the Joseon Dynasty, to allow children to experience the seonbi culture. Room 1 offers visitors an opportunity to experience a day in the life of a seonbi, while Room 2 is an experience space where visitors can enjoy a range of activities.

Here comes a Little Seonbi

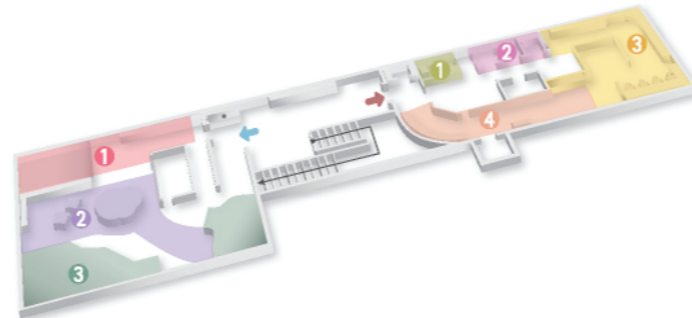

- ➡ 1 A Culture of Coexistence
- 2 Anbin nakdo
- 3 Hoyeon jigi
- ➡ 1 Teachings of the village school teacher
- 2 Dining Table Education
- 3 On the Way to Take the National Examination
- 4 The Path of a True Seonbi



1 Let's help parents (Room 1)

2 Martial Arts, venue of the National Examination

3 Coming first in the National examination!

4 Lounge

...

Outdoor Exhibition

Outdoor Exhibition

The Outdoor Exhibition is divided into three sections: ancient tombs, Buddhist art, and folk artifacts. The Baekje tombs at Doam-ri in Gunsan, Dunsan-ri in Wanju, and Pyeonghwa-dong in Jeonju were relocated here and restored. The Buddhist art section features a stone sculpture of a standing Buddha excavated at Museong-ri in Jeongeup, along with a stone pedestal carved with a lotus flower. The folk artifacts section includes replicas of stone guardian posts(jang seung) and guardian stone poles(so tdae) from Seooe-ri, Buan, stone towers from Daepyeong-ri in Muju, and phallic stones from Changdeok-ri in Suncheon, all of which represent the folk culture of North Jeolla-do Province. In addition, there are donated objects such as a stone statue of civil official (Gift of Hwang Byeong-geun) and a stone carving of a lamb (Gift of Hika Akio), both of which show aspects of traditional Korean funeral culture.

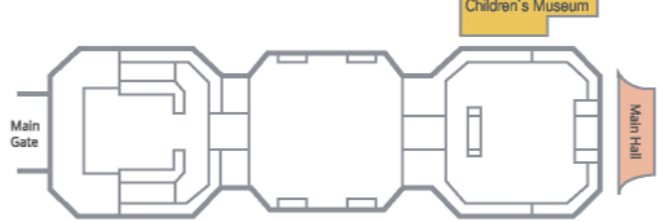

02 Stone Civil Official (Gift of Hwang Byeong-geun)

03 Stone Lamb (Donated by Hika Akio)

04 Stone Standing Buddha from Museong-ri in Jeongeup

01 Ancient Tombs (Doam-ri in Gunsan, Dunsan-ri in Wanju, and Pyeonghwa-dong in Jeonju)

01 Ancient Tombs (Doam-ri in Gunsan, Dunsan-ri in Wanju, and Pyeonghwa-dong in Jeonju)



02 Stone Civil Official (Gift of Hwang Byeong-geun)



03 Stone Sheep (Hika Akio)



04 Stone Standing Buddha from Museong-ri in Jeongeup



01 Ancient Tombs (Doam-ri in Gunsan, Dunsan-ri in Wanju, and Pyeonghwa-dong in Jeonju)

Facilities



Museum Shop

Located on the first floor of the main building, the Museum Shop offers diverse souvenirs, replicas of important cultural properties, crafts for everyday use, and books and catalogues on culture and history.

Hours of Operation | 10 AM – 6 PM



Café

The café on the second floor of the main building serves a variety of beverages and desserts.

Hours of Operation | 10 AM – 6 PM



Culture Room

Located on the first floor of the main building, the Culture Room (capacity: 53 seats) screens cultural films on weekdays and movies on weekends and during nighttime openings. Weekdays and Weekends | 11 AM, 2 PM
Night Screenings | 6 PM



Auditorium

The Auditorium (capacity: 234 seats) on the first floor of the main building hosts public lectures and seminars organized by museums and universities. As a cultural complex, it also holds special performances. It is also available for rent to the public for a wide range of activities.
Year-round | 10 AM – 6 PM (Except Closed Days)



Seminar Room

Seating 40 people, the Seminar Room on the first floor of the main building hosts public lectures and seminars and is also available for rent to the public for academic purposes.
Year-round | 10 AM – 6 PM (Except Closed Days)



Nursing Room

Located on the first floor of the main building and the third floor of the Children's Museum, nursing rooms are equipped with two chairs for breastfeeding, water dispenser, and sinks.

JEONJU NATIONAL MUSEUM

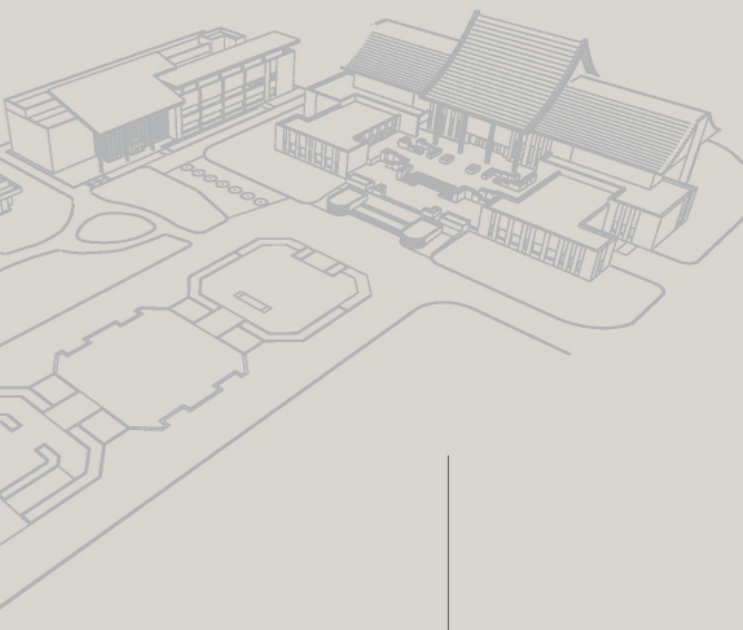

Homepage
jeonju.museum.go.kr
Mobile
mjeonju.museum.go.kr
Facebook
www.facebook.com/JeonjuMuseum
Instagram
https://www.instagram.com/explore/tags/JEONJU NATIONAL MUSEUM

...

Seonbi Culture Room

Seonbi, the classical scholars of the Joseon Dynasty, devoted themselves to study and the search for the righteous path, which they strived to follow in their daily life. The Seonbi Culture Room displays a variety of exhibits that explain in a detailed but accessible way the historical context, roles and culture of the Seonbi as the leaders and practical intellectuals of Joseon society.

1F

Major Exhibits

The Life of a Seonbi

- 101 Tomb Epitaph for Seo Mun-yeong
- 102 Xiaoxue (A Confucian Textbook for Children)
- 103 Hopae of Kim Hee
- 104 Official Uniform
- 105 Portrait of Song Si-yeol
- 106 Book of Seal Impressions

Seonbi as Leaders of Joseon Society

- 107 Writing Desk, Inkstone
- 108 Celestial Globe
- 109 Mongnimsimseo (Admonitions on Governing the People)

Preserving the Seonbi Spirit Through Culture

- 110 Funerary Object
- 111 Map of Jeonju-bu
- 112 Painting of Scholar's Equipment
- 113 Chart for Seungyeongdo (Government Career Ladder Climbing Game)
- 114 Album of Calligraphy and Paintings by Lee Jeong-jik
- 115 Dongui bogam, Medicine Mortar
- 116 Record of National Heroes of Korea



102 Xiaoxue (A Confucian Textbook for Children) 105 Portrait of Song Si-yeol 108 Celestial Globe 112 Painting of Scholar's Equipment

...

Realistic Contents Space: Seonbi and Nature

The Seonbi Culture Room comprises a realistic contents space and an exhibition space where visitors can enjoy a tangible experience of the natural world as seen through the eyes of the Seonbi.

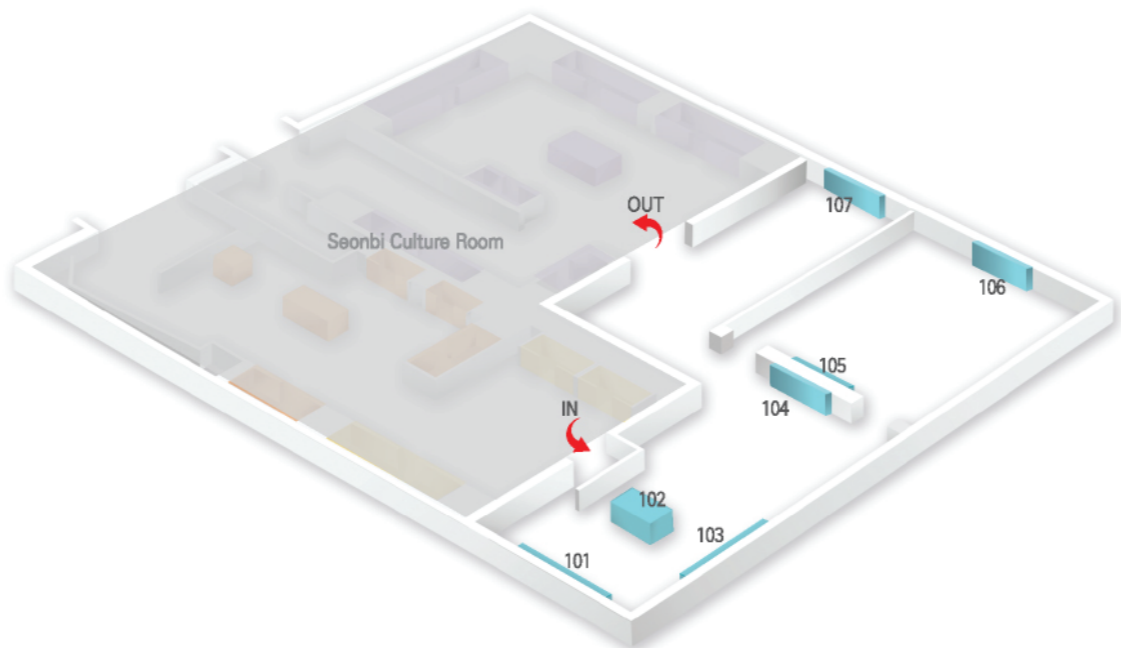

102 The spirit of Seonbi embodied in a cup of tea 103 Seonbi in nature 107 Seonbi, starting a sightseeing tour

1F

Theme

Realistic Contents Space: Seonbi and Nature

- 101 An astronomical chart
- 102 The spirit of Seonbi embodied in a cup of tea
- 103 Seonbi in nature
- 104 A view of a Seowon (Confucian academy)
- 105 On Mandaeru Pavilion
- 106 Seowon, nurturing the spirit of Seonbi
- 107 Seonbi, starting a sightseeing tour

...

Prehistory and Ancient History Gallery

The wide range of artifacts in this gallery presents the flow of prehistoric and historical culture in North Jeolla-do Province (Jeonbuk) Province. The exhibition centers on five themes: "The Beginning of Prehistoric Culture in Jeonbuk," "The Origin and Development of Mahan," "From Mahan to Baekje," "Jeonbuk: A Cultural Buffer Zone between Ancient Kingdoms," and "The Baekje Revival and Later Baekje." In addition to recently excavated artifacts, the space displays about 2,000 objects, including a bronze mirror with a fine linear design from Sinpung, Wanju that represents the early Iron Age culture of the area and a pair of decorated gilt-bronze shoes from Bongdeok-ri, Gochang that characterizes the culture of the powerful Mahan confederacy in the regions of Jeonbuk. These objects offer visitors the opportunity to better understand the diverse and dynamic ancient cultures that once thrived in the region.

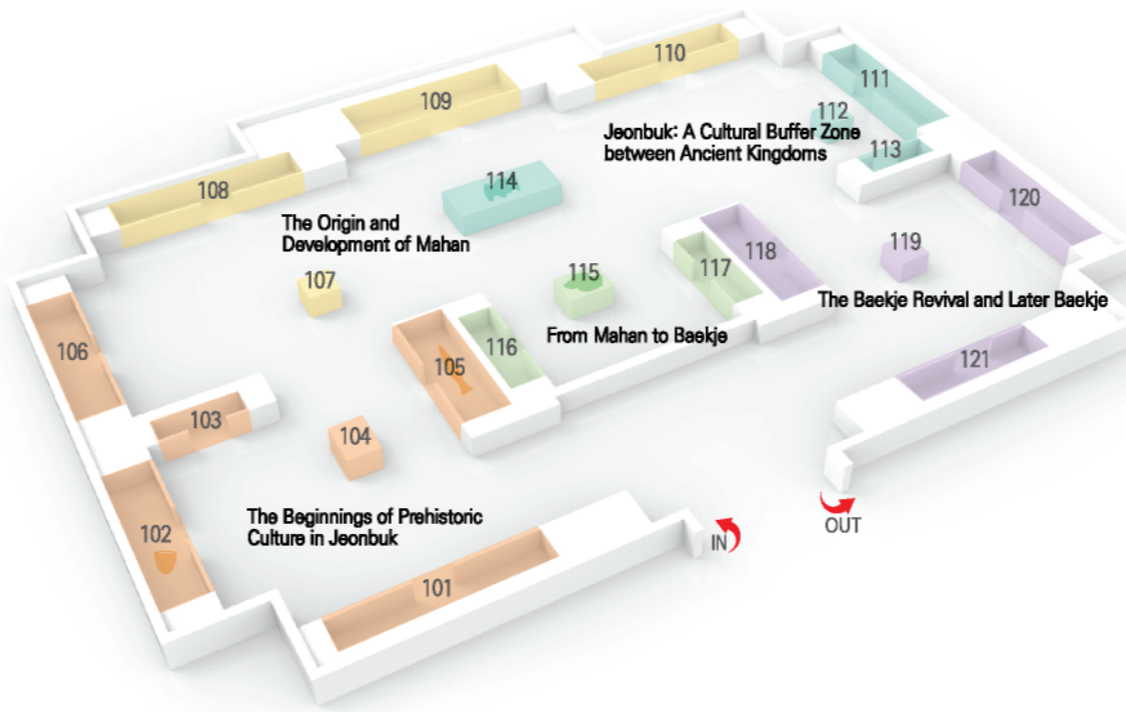

106 Mold, Korean Style Bronze Dagger, Mirror with Fine Linear Design, Beads 113 Celadon Jar with a Rooster Head Decoration 115 Gilt-bronze Decorated Shoes 121 Roof Tile with the Inscription of 'Jeonjujeong Fortress'

1F

Major Exhibits

The Beginnings of Prehistoric Culture in Jeonbuk

- 101 Tanged Points
- 102 Comb-patterned Pottery
- 103 Farming Tools
- 104 Bronze Mirror with Coarse Linear Design
- 105 Polished Stone Daggers
- 106 Mold, Korean Style Bronze Dagger, Mirror with Fine Linear Design, Beads

The Origin and Development of Mahan

- 107 Bronze Mirror
- 108 Artifacts Excavated from the Archaeological Sites in Gal-dong, Wanju
- 109 Smithy Tools
- 110 Cylindrical Pottery

Jeonbuk: A Cultural Buffer Zone between Ancient Kingdoms

- 111 Vessel Stand
- 112 Helmet, Gorget, and Scale Armor
- 113 Celadon Jar with a Rooster Head Decoration
- 114 Mounted Jar with Long Neck

From Mahan to Baekje

- 115 Gilt-bronze Decorated Shoes
- 116 Gilt-bronze Cowl Cap
- 117 Long-necked Jar

The Baekje Revival and Later Baekje

- 118 Roof Tile with the Inscription of "Capital" and Roof Tile with the Inscription of "Central Region"
- 119 Iron Saucer
- 120 Roof Tile with the Inscription of "Gummajaejeong Fortress"
- 121 Roof Tile with the Inscription of "Jeonjujeong Fortress"

...

Fine Arts Gallery

Objects displayed in this gallery include Buddhist art objects, ceramic ware, wooden lacquerware, and hanji (Korean traditional paper) handicrafts that were excavated or produced in North Jeolla-do Province (Jeonbuk). These objects are collected into three sections: "Jeonbuk Buddhist Culture," "Jeonbuk Ceramic Culture," and "Woodcraft and Hanji Craft." The Jeonbuk Buddhist Culture section displays diverse Buddhist artifacts such as Reliquaries from the Five-story Stone Pagoda in Wanggung-ri, Iksan (National Treasure No. 123). The next section features artifacts unearthed from kiln sites in Yucheon-ri, Buan, the major production area for Goryeo celadon, as well as artifacts excavated from early celadon kiln sites in Dotong-ri, Jinan and items excavated from representative Joseon-period buncheong kiln sites in Yongsan-ri, Gochang. All of these embody the ceramic culture of North Jeolla-do Province. Hanji craftworks made in Jeonju during the Joseon period are exhibited in the third section, which allows visitors to retrace the lives of local residents.

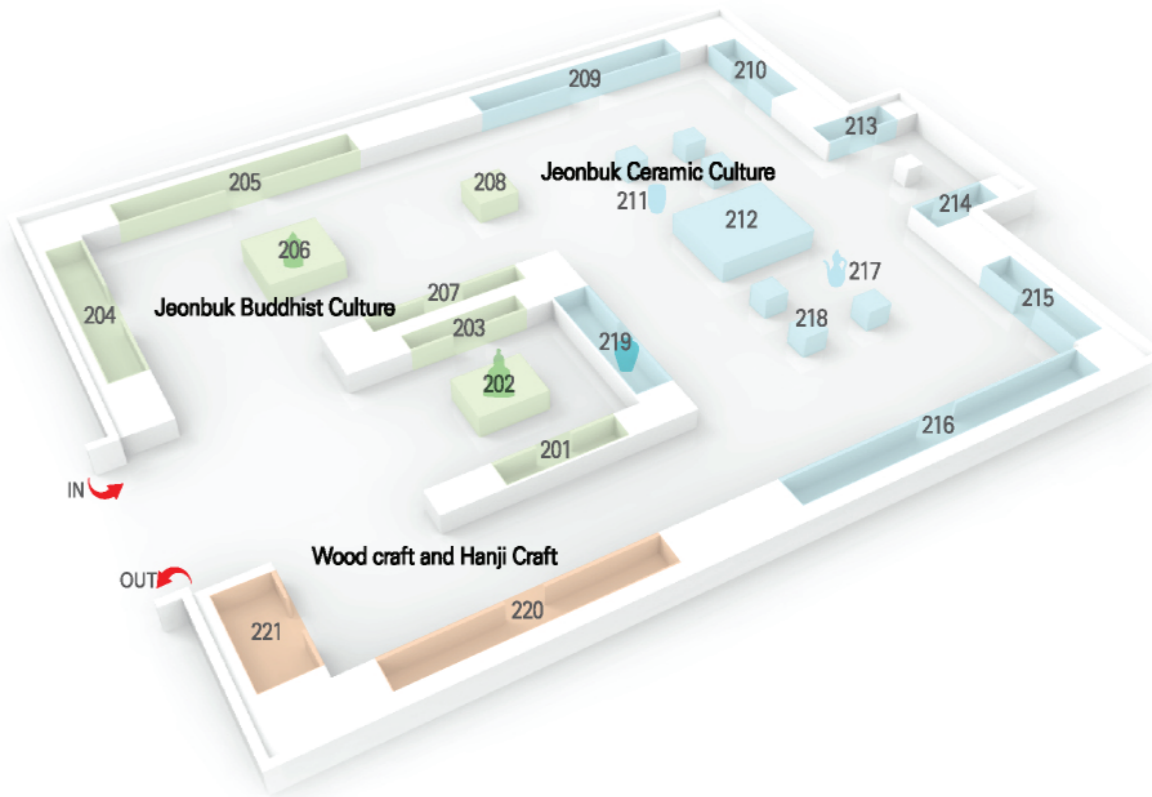

204 Sarira Bottle and Inner Casket 206 Buddhist Bell Known Unearthed from Naksujeong Pavilion 218 Celadon Maebyeong with Dragon Design 221 Fan with Taeguk Design

2F

Major Exhibits

Jeonbuk Buddhist Culture

- 202 Buddhist Sculpture
- 204 Sarira Bottle and Inner Casket
- 205 Terracotta Head of Deva
- 206 Incense Burner
- 206 Buddhist Bell from Naksujeong Pavilion
- 207 Buddhist Gong
- 208 Bash with Dragon Design

Jeonbuk Ceramic Culture

- 209 Celadon Shards
- 210 Celadon Flower-shaped Dish
- 211 Celadon Chair with Openwork Decoration
- 212 Celadon Melon-shaped Ewer
- 213 Celadon Cup and Stand
- 213 Celadon Shards
- 214 Goryeo White Porcelain Shards
- 215 Celadon Cup and Stand
- 216 Celadon Dish with Chrysanthemum Design
- 217 Celadon Ewer with Grape Design
- 218 Celadon Maebyeong with Dragon Design
- 219 Buncheong Jar with Fish Design

Woodcraft and Hanji Craft

- 220 Reading Desk
- 221 Fan with Taeguk Design